



Pier 27

Social Package

Pier 27, San Francisco's premiere modern event venue located along the Embarcadero waterfront. Built from contemporary materials of steel, concrete and glass. Expansive square footage across two levels gives guests plenty of space to mingle and your imagination of room to room.

THE VENUE

⚓ Pier 27

Pier 27 is an industrial chic canvas ready to transform for any special occasion. Featuring floor to ceiling windows offering breathtaking views of Telegraph Hill, Coit Tower, the city skyline and the iconic Bay Bridge.



Dreamy views of the iconic Bay Bridge and the downtown San Francisco city skyline.

Ceremony and reception spaces available on both levels.

Offering event space for weddings and social events up to 800 guests

Industrial architectural design suited for the modern taste or the creative minds that like to think outside the box.

Outdoor space nearby and on site for pre wedding photo shoots and first look.

Preferred Vendor List featuring some of San Francisco's most esteemed wedding and event caterers and service providers.

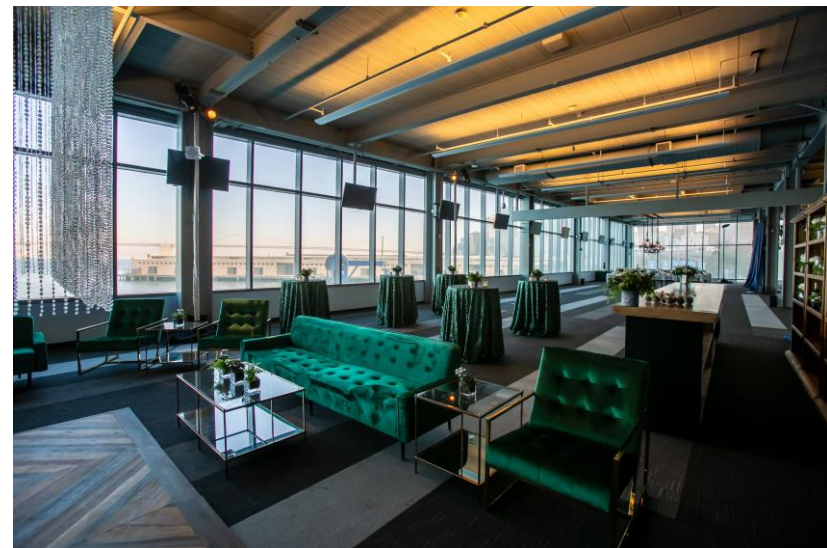

PIER 27 UPPER LEVEL

RENTAL INCLUDES

UPPER LEVEL

City View Room

Cocktail, reception and ceremony
Balcony access

Bay View Room

Catering, bridal or wedding party suite
Balcony access

Alcatraz Outdoor Space

Located on the lower level and used for catering
prep and staging – no guest access

~ 200 – 800 guests ~



PIER 27 – COIT ROOM

RENTAL INCLUDES

UPPER LEVEL

Cocktails, Reception,
Ceremony space

Alcatraz Outdoor Space

Located on the lower level and used for catering
prep and staging – no guest access

~ 100 – 300 guests ~



PIER 27 LOWER LEVEL

RENTAL INCLUDES

LOWER LEVEL

Embarcadero Room

Cocktail, reception and ceremony
Pier side access

Alcatraz Outdoor Space

Located on the lower level and used for catering
prep and staging – no guest access

~ 200 – 800 guests ~



Monitors

Two welcome monitors located in the lobby and three additional monitors upstairs available for use.

Parking Lot

112 spots (175 with valet). Available for event parking.

Free WIFI

Up to 20 MBPS included.

Security

On site building security provided at venue access points for the duration of the rental.

Facility Custodian

On site to refresh and service restrooms for the duration of the rental. Sweeping and vacuuming available upon request.

Post Event Cleaning

Deep clean of the venue the day following.

Onsite Venue Manager

Main point of contact on the day of the event to oversee vendor load in, set up and breakdown. Please note the Venue Manager will not assist with any on site coordination of the event. A coordinator is required onsite and must be available to communicate with the Metro Events team a minimum of six months prior to the wedding.



Booking Calendar

Available for booking one year in advance.
A hold can be placed on the calendar up to 14 months in advance.

Payments

To confirm a date a 50% deposit is required upon signing a contract. Final payment is due thirty days prior to the event date.

Challenge Process

If your desired date is being held by another client you have the opportunity to challenge the hold. A signed contract and 50% deposit payment is required before the challenge is initiated. Once the challenge has been initiated the first hold will have up to 3 business days to move forward or release the date.



Site Visits

Required a minimum of two weeks prior to the event day. Onsite attendance is mandatory for all vendors.

Before Your Event

Final floor plan, vendor list and proof of insurance is due no later than thirty calendar days prior to the event date.

Port Fire Inspector

Must review and approve floor plans no later than three weeks prior to the event. At this time fire permits will be filed and paid for by the caterer, if needed. Events taking place on the weekend will be charged an overtime inspection fee. Metro Events and approved caterer will assist with filing permits and the Fire Inspector meeting.



How far in advance can I confirm our event?

Metro Events will be able to confirm your event one year prior to your event date.

Can I place a hold on my preferred date?

A complimentary hold can be placed on up to two dates. Holds are valid for up to thirty days. If you need additional time to make a decision on your hold please reach out to your sales lead to request an extension.

How do I set up a site visit?

Site visits are available Monday-Friday when Pier 27 is not occupied by cruise ships or events. Please reach out to your sales lead for availability.

What is included in the social package?

The social package includes City View, Bay View and Alcatraz for catering for the 12 hour duration. The social package also includes five monitors, guest parking, WiFi, venue security and janitorial. Electricity, heat, A/C and one Recology bin are also included.

What is NOT included in the social package?

Metro Events does not provide furniture, AV equipment, lighting, décor, signage, florals, food and beverage, entertainment or any other event element needed to host your event. Please refer to our list of preferred vendors, or feel free to bring in the vendors of your choice.

Can I bring in my own caterer or am I required to select one from the approved list?

Metro Events has a list of approved caterers that we require you to select from. Please refer to the Metro Events Vendor List for the complete list and contact information.

What are the rules around serving alcohol? Who pulls the permit?

Metro Events does not have a liquor license to serve alcohol. We grant permission to the catering companies who hold liquor licenses and liquor liability to serve onsite.

Is there storage available onsite before or after the event?

There is no storage available onsite pre or post event. All items MUST be removed from the venue after the event or additional fees may be billed.

Are there dimming capabilities on the house lights?

There are NO dimming capabilities.

Who is my main contact? Will they be present on my event day?

A sales manager will work with you to show you the venue, check availability and execute contracts. Once the date has been confirmed, your main point of contact will be a Metro Events operations representative who will help review the floor plan, production schedule and vendor list with your event planner. On the day of event, a venue manager will be onsite to oversee the event.

Are you accessible to guests with special needs?

Absolutely! Pier 27 is an ADA accessible building which has 2 escalators and 2 elevators available.

Do I need an event planner?

A planner is required on site and must be available to communicate with the Metro Events team a minimum of six months prior to the event date.



Pier 27

Contact the Metro Events team
to book your event at Pier 27

info@metroevents.com

415 298-1913

metroevents.com